

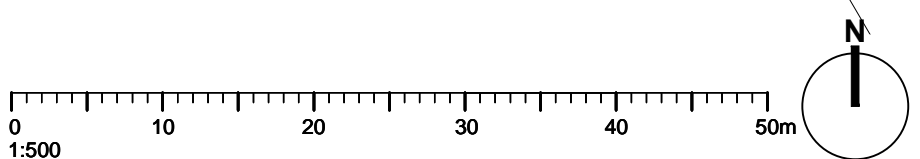

- KEY**
- 3 bed houses
 - 4 bed houses
 - 4 bed houses
 - 2 bed flats
 - 1 bed flats
 - community buildings



WOODFIELD BRADY
architects

Client / Project
Thomas Homes Ltd
Mixed-use Development

Project Address
Sites in
Long Wittenham

| OUTLINE PROPOSALS - SIT EPLAN | | | | |
|-------------------------------|-------|--------------|--------------|------|
| Date | Drawn | Scale / Page | Drawing ref. | Rev. |
| MAY '17 | KJB | 1:500 @ A1 | 970.03 | |

arlington house . curridge . west berkshire . rg18 9ef
t 01635 247 100 f 01635 247 070 e mail@woodfieldbrady.co.uk www.woodfieldbrady.co.uk

All dimensions to be checked on site prior to construction. Do not scale except for planning purposes.
Any discrepancy between this drawing and other information to be referred to the architects.

Issued for:
Comment



aerial view from south



access to site

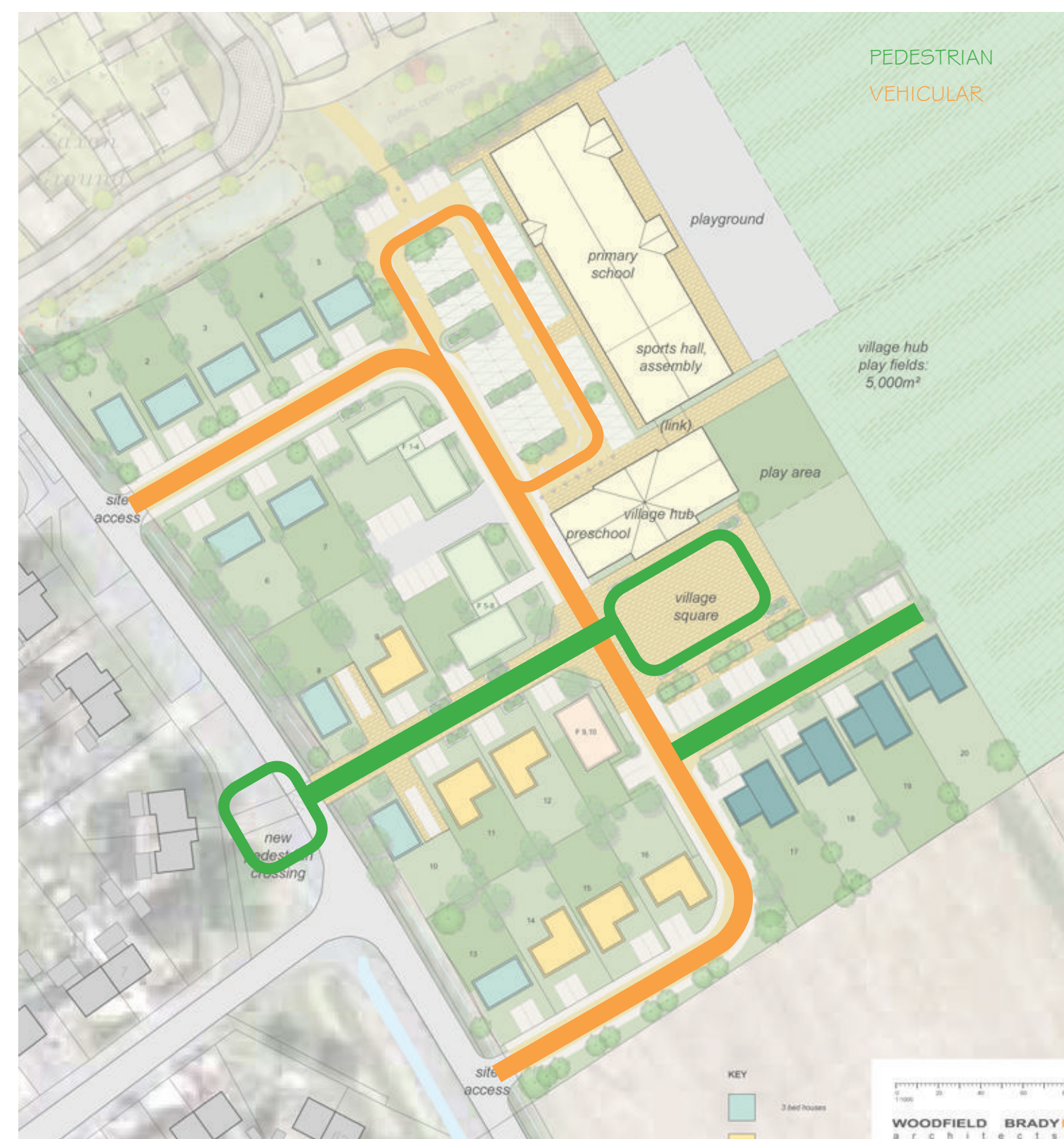

routes & nodes

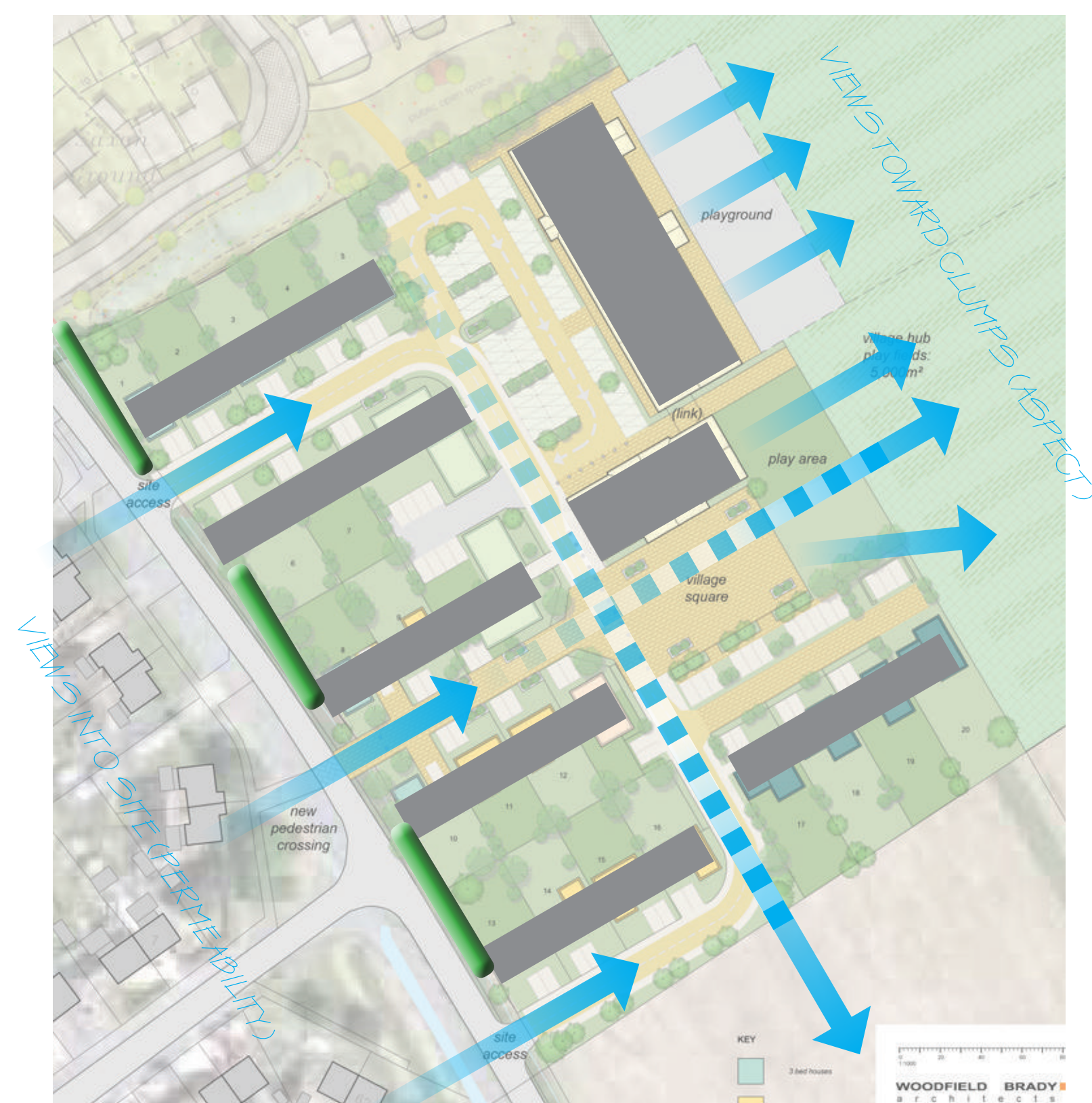

visibility through site



south-facing village square



visibility and access through the site, permeability



village hub, square and school open up to the eastern landscape



pedestrian link from Didcot Road, via a quiet cul-de-sac - opens onto village square and landscape beyond



south-facing village square with planting and play space



PRIMARY SCHOOL, NURSERY

PLAN BASED ON EDUCATION FUNDING AGENCY MODEL:

105 PLACE PLACE JMI PRIMARY SCHOOL 4-11 TYPICAL CURRICULUM

NOTE: INDICATIVE PLAN ONLY - FINAL LAYOUT TO BE AGREED
IN CONSULTATION WITH OXFORDSHIRE COUNTY COUNCIL

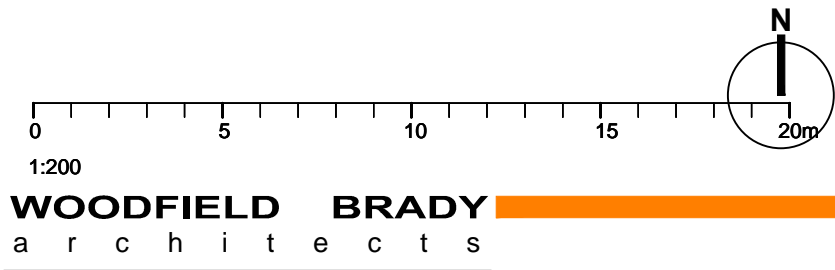

Client / Project
Thomas Homes Ltd
Project Address
Sites in
Long Wittenham
Mixed-use Development

Drawing Title
PRIMARY SCHOOL, NURSERY

| Date | Drawn | Scale / Page | Drawing ref. | Rev. |
|----------|-------|--------------|--------------|------|
| SEPT '16 | JC/AW | 1:200 @ A2 | 970.04 | © |

arlington house . curridge . west berkshire . rg18 9ef
t 01635 247 100 f 01635 247 070 e mail@woodfieldbrady.co.uk www.woodfieldbrady.co.uk

All dimensions to be checked on site prior to construction. Do not scale except for planning purposes.
Any discrepancy between this drawing and other information to be referred to the architects.
Issued for:
Comment

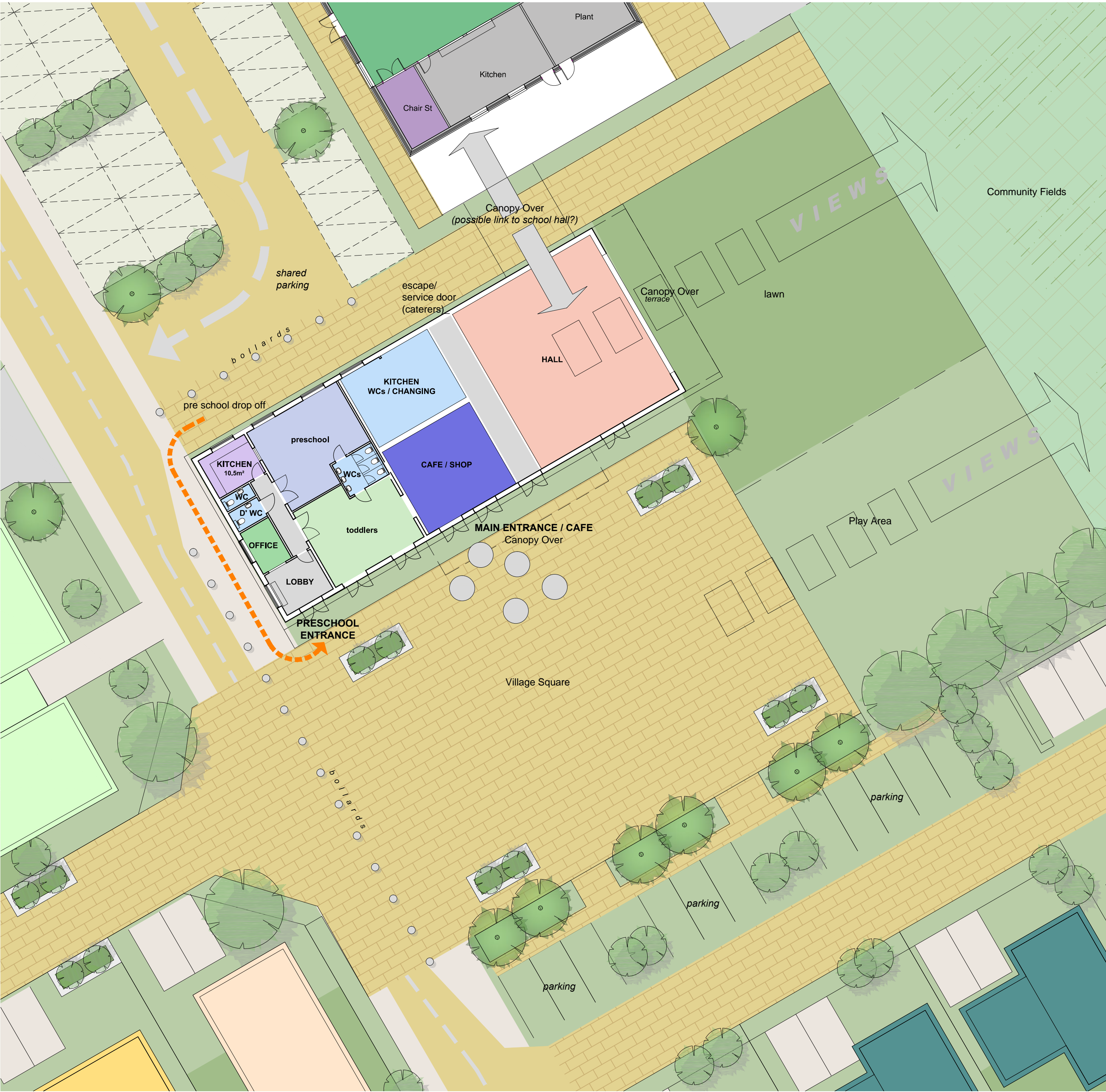

- VILLAGE HUB
- PRESCHOOL
 - COMMUNITY HALL WITH VIEWS TOWARDS WITTENHAM CLUMPS AND ACCESS TO LAWN
 - CAFE WITH ACCESS TO VILLAGE SQUARE
 - KITCHEN, WCs, CHANGING & STORE
 - COVERED LINK TO SCHOOL HALL

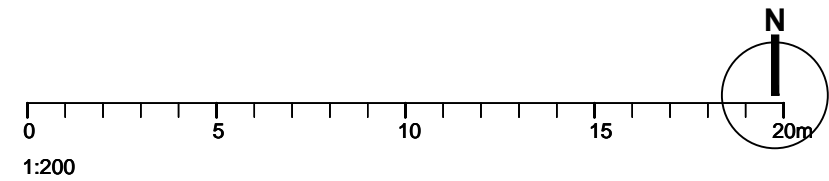

1:200
WOODFIELD BRADY
a r c h i t e c t s

Client / Project
Thomas Homes Ltd
Project Address
Sites in
Long Wittenham
Mixed-use Development

Drawing Title
VILLAGE HUB

| Date | Drawn | Scale / Page | Drawing ref. | Rev. |
|---------|-------|--------------|--------------|------|
| MAY '17 | KJB | 1:200 @ A2 | 970.05 | € |

arlington house . curridge . west berkshire . rg18 9ef
t 01635 247 100 f 01635 247 070 e mail@woodfieldbrady.co.uk www.woodfieldbrady.co

All dimensions to be checked on site prior to construction. Do not scale except for planning purposes.
Any discrepancy between this drawing and other information to be referred to the architects.
Issued for:
Comment